



T3034A-PA136 SYSTEM DATASHEET



SYSTEM PERFORMANCE	METRIC	IMPERIAL
Sine Force Peak kN (lbf)	29.4	6,609
Random Force rms kN (lbf)	20.6	4,627
Shock Force (6ms) kN (lbf)	58.8	13,219
Useful Frequency Range Hz	2 - 3000	2 - 3000
Continuous Displacement mm (in)	100	3.9
Shock Displacement mm (in)	100	3.9
Max Velocity m/s (in/s)	2.4	94.5
Max Acceleration Sine Peak m/s ² (g)	784	80

Air-cooled long-stroke system designed for demanding test requirements normally performed by hydraulic shakers. Accommodates a wide-variety of test requirements with attendant time and cost savings. Ideally suited for transportation /package testing.

- Automatic static and dynamic armature centering
- Motorized gearbox for shaker rotation standard
- Useable frequency range 2 - 3000 Hz
- Max static payload 500 kg (1102 lb)
- Air-cooled amplifier efficiency > 90%
- Rugged air-isolated trunnion

T3044A SHAKER	METRIC	IMPERIAL
Armature Diameter mm (in)	340	17.5
Armature Material	Al	Al
Effective Armature Mass kg (lb)	37.5	82.7
Armature Insert Pattern PCD mm (in)	160, 280	6.3, 11.0
Armature Insert Threads	16-M10	3/8-16UNC
First Resonant Frequency (bare table) ±5% Hz	2,440	2,440
Max Static Payload kg (lb)	500	1,102
Natural Frequency Thrust Axis Hz	< 5	< 5
Stray Flux Density gauss	< 10	< 10
Shaker Weight Uncrated kg (lb)	3,000	6,614
Dimensions Uncrated (W x D x H) mm (in)	1220 x 926 x 1184	48.0 x 36.5 x 46.6

SLIP TABLES

Mono-base slip tables in a wide-range of sizes and configurations for maximum over-turning moment and cross-axial restraint

PA136 POWER AMPLIFIER	METRIC	IMPERIAL
Number of Sub-modules Supplied	8	8
Rated Power Output kVA	40	40
Rated Output Voltage V rms	100	100
Rated Output Current A rms	360	360
Number of Cabinets	1	1
System Required Power kVA	45	45
Amplifier Weight Uncrated kg (lb)	450	992
Dimensions Uncrated (W x D x H) mm (in)	580 x 850 x 1750	22.8 x 33.5 x 68.9

OPTIONS & ACCESSORIES

Sentek Dynamics offers a wide selection of options and accessories for unique applications and complete turn-key systems.

- Custom armature and slip table insert patterns and threads available
- Air-isolation feet, pads and mounts to eliminate need for seismic floor
- Thermal barrier for use with environmental test chambers
- Remote control panel for remote operation

BU-3 BLOWER	METRIC	IMPERIAL
Standard Air Hose Length m (ft)	5	16.4
Hose Diameter mm (in)	200	7.9
Blower Unit Weight Uncrated kg (lb)	260	573
Dimensions Including Silencer(W x D x H) mm (in)	1300 x 1200 x 1960	51.2 x 47.2 x 77.2



SHAKER MODEL T3044A

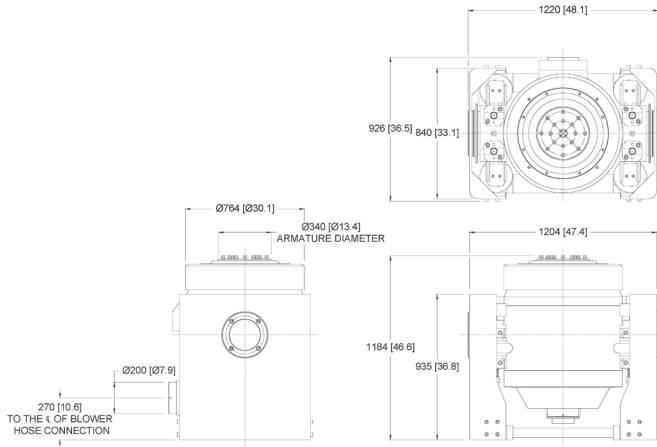

POWER AMPLIFIER MODEL PA136

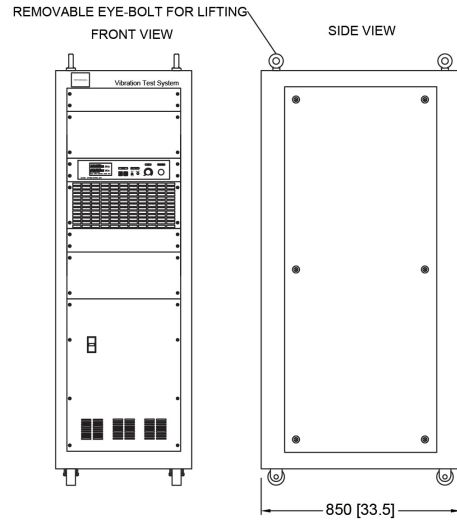

ARMATURE INSERT PATTERN

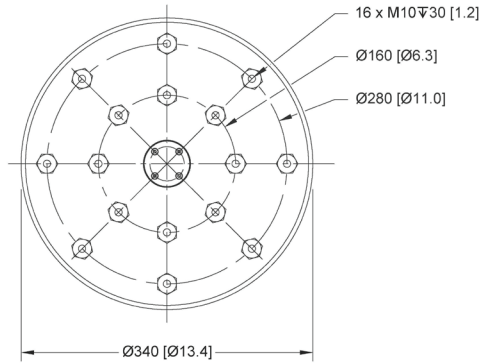

BLOWER UNIT MODEL BU-3

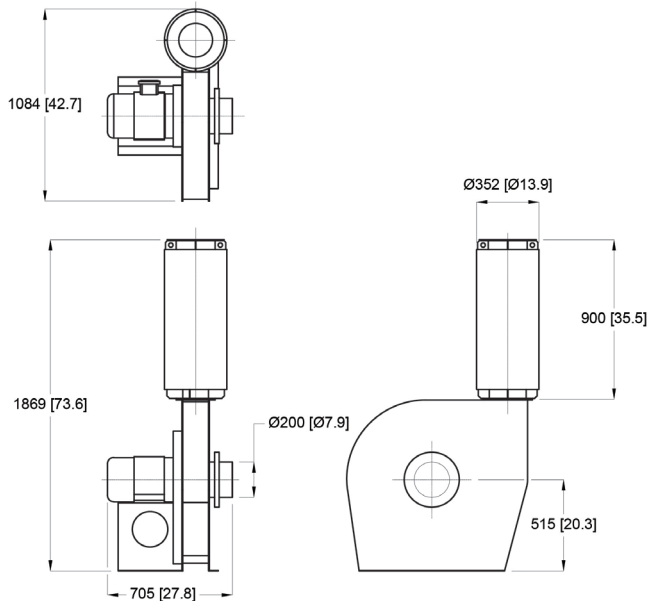

SENTEK DYNAMICS
 2370 OWEN STREET
 SANTA CLARA, CA 95054
 UNITED STATES OF AMERICA

PHONE: +1.408.200.3100 | FAX: +1.408.659.8229 | WWW.SENTEKDYNAMICS.COM | SALES@SENTEKDYNAMICS.COM

© 2016 Sentek Dynamics, All Rights Reserved. 12/2016

Notice: This document is for informational purposes only and does not set forth any warranty, expressed or implied, concerning any equipment, equipment feature, or service offered or to be offered by Sentek Dynamics. Sentek Dynamics reserves the right to make changes to this document at any time, without notice, and assumes no responsibility for its use. This informational document describes features that may not be currently available. Contact a Sentek Dynamics sales representative for information on features and product availability.

