



M5044A-PA155 SYSTEM DATASHEET



SYSTEM PERFORMANCE	METRIC	IMPERIAL
Sine Force Peak kN (lbf)	49.00	11,015
Random Force rms kN (lbf)	49.00	11,015
Shock Force (6ms) kN (lbf)	98.00	22,031
Useful Frequency Range Hz	5 - 2500	5 - 2500
Continuous Displacement mm (in)	51	2.0
Shock Displacement mm (in)	51	2.0
Max Velocity m/s (in/s)	2	78.7
Max Acceleration Sine Peak m/s ² (g)	980	100

Air-cooled system ideally suited to test medium-sized electronic parts, flight and ground vehicle components and assemblies.

- Continuous displacement 51 mm (2.0 in)
- Useable frequency range 5 - 2500 Hz
- Max static payload 1000 kg (2205 lb)
- Air-cooled amplifier efficiency > 90%
- Rugged isolated trunnion

M5044A SHAKER	METRIC	IMPERIAL
Armature Diameter mm (in)	445	17.5
Armature Material	Al	Al
Effective Armature Mass kg (lb)	49	108
Armature Insert Pattern PCD mm (in) plus 1 in center	8-160/8-280/8-400	8-6/8-11/8-16
Armature Insert Threads	M16	5/8-11UNC
First Resonant Frequency (bare table) ±5% Hz	2,250	2,250
Max Static Payload kg (lb)	1,000	2,205
Natural Frequency Thrust Axis Hz	< 5	< 5
Stray Flux Density gauss	< 10	< 10
Shaker Weight Uncrated kg (lb)	3,800	8,378
Dimensions Uncrated (W x D x H) mm (in)	1566 x 1050 x 1125	61.7 x 41.4 x 44.3

SLIP TABLES

Mono-base slip tables in a wide-range of sizes and configurations for maximum over-turning moment and cross-axial restraint

OPTIONS & ACCESSORIES

Sentek Dynamics offers a wide selection of options and accessories for unique applications and complete turn-key systems.

- Custom armature and slip table insert patterns and threads available
- Air-isolation feet, pads and mounts to eliminate need for seismic floor
- Thermal barrier for use with environmental test chambers
- Remote control panel for remote operation

PA155 POWER AMPLIFIER	METRIC	IMPERIAL
Number of Sub-modules Supplied	12	12
Rated Power Output kVA	55	55
Rated Output Voltage V rms	105	105
Rated Output Current A rms	525	525
Number of Cabinets	1	1
System Required Power kVA	75	75
Amplifier Weight Uncrated kg (lb)	650	1,433
Dimensions Uncrated (W x D x H) mm (in)	580 x 850 x 1840	22.8 x 33.5 x 72.4

BU-4 BLOWER	METRIC	IMPERIAL
Standard Air Hose Length m (ft)	5	16.4
Hose Diameter mm (in)	250	9.8
Blower Unit Weight Uncrated kg (lb)	320	705
Dimensions (W x D x H) mm (in)	1300 x 1200 x 1960	51.2 x 47.2 x 77.2



SHAKER MODEL M5044A

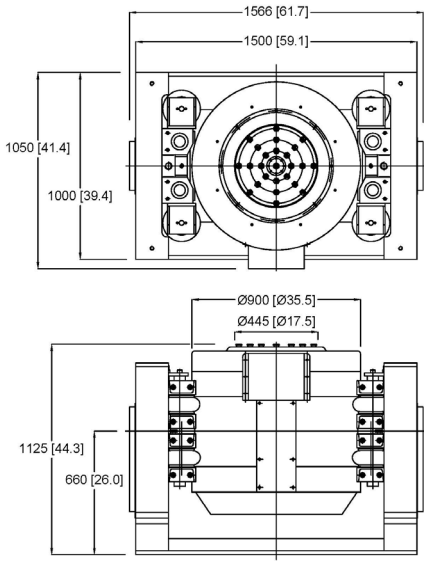

POWER AMPLIFIER MODEL PA155

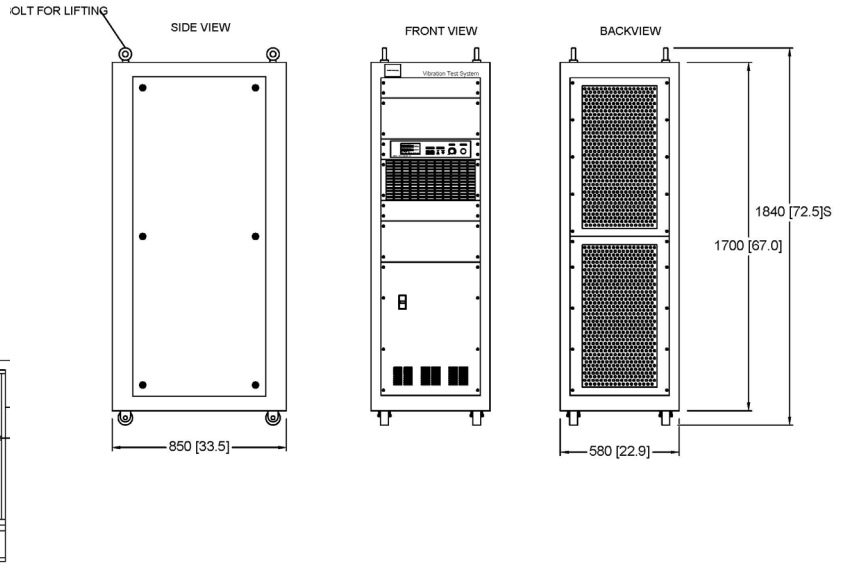

ARMATURE INSERT PATTERN

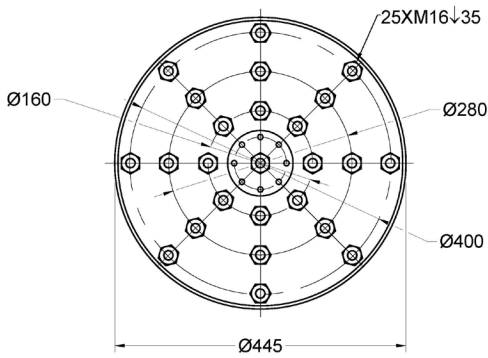

BLOWER UNIT MODEL BU-4

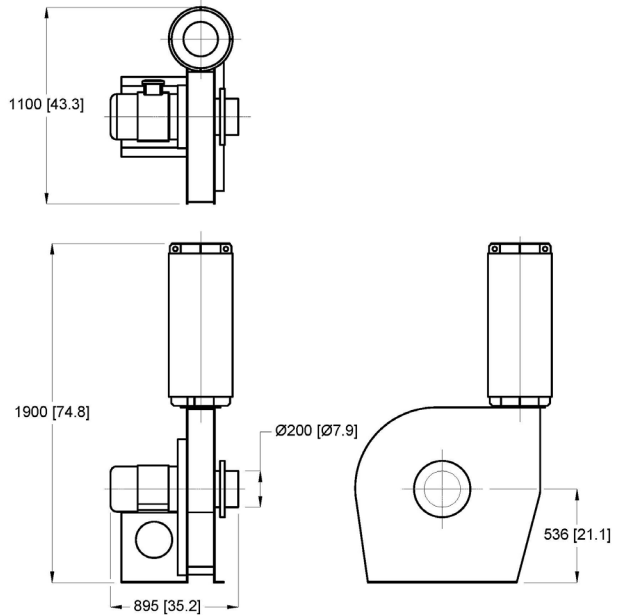

SENTEK DYNAMICS
2370 OWEN STREET
SANTA CLARA, CA 95054
UNITED STATES OF AMERICA

PHONE: +1.408.200.3100 | FAX: +1.408.659.8229 | WWW.SENTEKDYNAMICS.COM | SALES@SENTEKDYNAMICS.COM

© 2017 Sentek Dynamics, All Rights Reserved. 03/2017

Notice: This document is for informational purposes only and does not set forth any warranty, expressed or implied, concerning any equipment, equipment feature, or service offered or to be offered by Sentek Dynamics. Sentek Dynamics reserves the right to make changes to this document at any time, without notice, and assumes no responsibility for its use. This informational document describes features that may not be currently available. Contact a Sentek Dynamics sales representative for information on features and product availability.