

PROPRIETARY AND CONFIDENTIAL

THE INFORMATION CONTAINED IN THIS DRAWING IS THE SOLE PROPERTY OF DYTRAN INSTRUMENTS INC. ANY REPRODUCTION IN PART OR AS A WHOLE WITHOUT THE WRITTEN PERMISSION OF DYTRAN INSTRUMENTS INC. IS PROHIBITED

REVISIONS

REV.	ECN	DESCRIPTION	BY/DATE	CHK	APPR
A	14187	INITIAL RELEASE, SAME AS X1	DP 03/27/19	sp	lw

1 CABLE LENGTH TOLERANCE

ENGLISH		METRIC	
≤1FT	+1/ -0 IN	≤0.3m	+25mm/-0mm
>1 FT - 5 FT	+2/ -0 IN	>0.3m-1.5m	+50mm/-0mm
> 5 FT - 10 FT	+4/ -0 IN	>1.5m-3m	+100mm/-0mm
>10 FT - 25FT	+6 / -0 IN	>3m-7.5m	+150mm/-0mm
>25 FT	+5% / -0%	>7.5m	+5%-0%

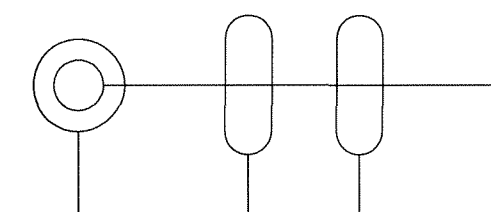
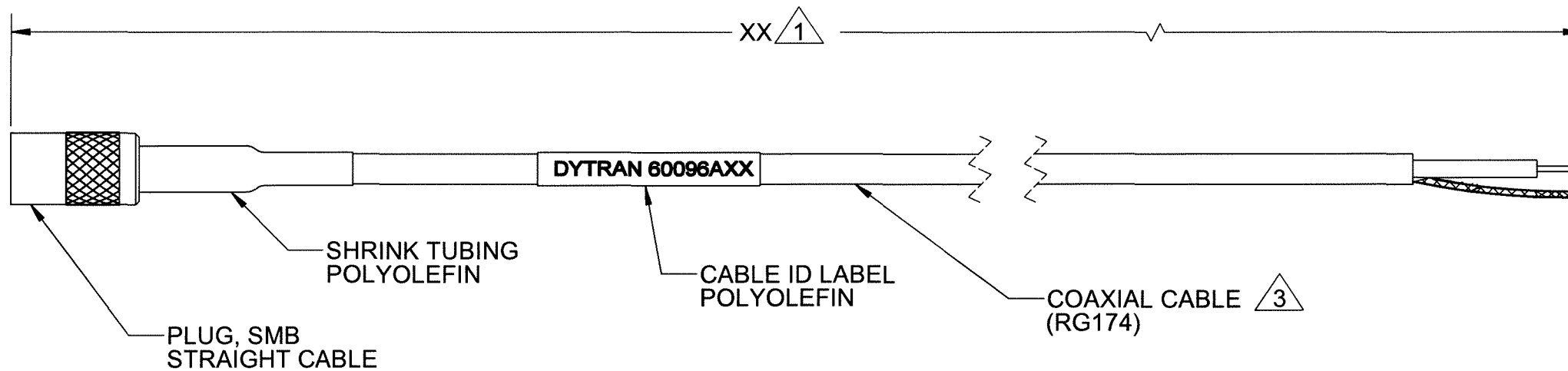
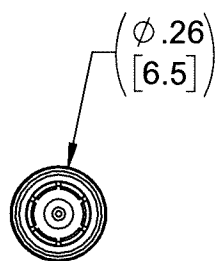

SCHEMATIC DIAGRAM

3 RG174AU COAX CABLE	
INNER CONDUCTOR	26 AWG 7/34 BARE COPPER CLAD STEEL (COPPER WELD)
DIELECTRIC MATERIAL	EXTRUDED POLYOLEFIN
SHIELD	BRAIDED TINNED COPPER, 38 AWG, 4 ENDS, 85% MIN COVERAGE
JACKET	EXTRUDED PVC (NON-CONTAMINATING), COLOR BLK
DIAMETER	.110±.005
TEMPERATURE RATING	-40 °C TO 85 °C
NOMINAL IMPEDANCE (OHMS)	50±2
MAX CONDUCTOR RESISTANCE (OHMS)	9.67 / 100FT

UNLESS OTHERWISE SPECIFIED:
 INTERPRET DIM & TOL PER ASME Y14.5M - 1994.
 REMOVE BURRS.
 COUNTERSINK INTERNAL THDS 90° TO MAJOR DIA.
 CHAM EXT THDS 45° TO MINOR DIA.
 THD LENGTHS AND DEPTHS ARE FOR MIN FULL THDS.
 DIMENSIONS APPLY AFTER FINISHING.

DECIMALS	METRIC	ANGLES
.XX ±.03	.X ± 0.8	±1°
.XXX ±.010	.XX ±0.25	

APPROVALS		DATE
ORIG	DP	05/01/18
CHK	sp	4/11/19
APP	lw	4/2/19

ALL MACHINED SURFACES TOTAL RUNOUT WITHIN .005. BREAK SHARP EDGES .005 TO .010. MACHINED FILLET RADII .005 TO .015. WELDING SYMBOLS PER AWS A2.4. ABBREVIATIONS PER MIL-STD-12.

DYTRAN INSTRUMENTS, INC. Chatsworth, CA
MASTER ONLY IF IN RED

TITLE: OUTLINE/INSTALLATION DRAWING, MODEL 60096A			
SIZE B	CAGE CODE 2W033	DWG NO 127-60096A	REV A
SCALE: 2:1	SHEET 1 OF 1		

- 3 SEE TABLE FOR CABLE SPECIFICATIONS
 - 2. TEMPERATURE RATING: -40°F (-40°C) TO +185°F (+85°C)
 - 1 PART NUMBER 60096AXX (XX DENOTES LENGTH IN FEET). SEE TABLE FOR TOLERANCE.
- NOTES: UNLESS OTHERWISE SPECIFIED