

PROPRIETARY AND CONFIDENTIAL

THE INFORMATION CONTAINED IN THIS DRAWING IS THE SOLE PROPERTY OF DYTRAN INSTRUMENTS INC. ANY REPRODUCTION IN PART OR AS A WHOLE WITHOUT THE WRITTEN PERMISSION OF DYTRAN INSTRUMENTS INC. IS PROHIBITED

1 CABLE LENGTH TOLERANCE

ENGLISH		[METRIC]	
≤1FT	+1/ -0 IN	≤0.3m	+25mm -0mm
>1 FT - 5 FT	+2/ -0 IN	.0.3 m-1.5m	+50mm -0mm
> 5 FT - 10 FT	+4/ -0 IN	>1.5m-3m	+100mm -0mm
>10 FT - 25FT	+6 / -0 IN	>3m-7.5m	+150mm -0mm
>25 FT	+5% / -0%	>7.5m	+5%/-0%

REVISIONS

REV.	ECN	DESCRIPTION	BY/DATE	CHK	APPR
A	13079	INITIAL RELEASE	LA 10/27/16	EM	LN
B	13524	SHT 2 OF 2 ADDED CONNECTOR MATING DETAIL	RA, 06/28/17	EM	AS
C	13956	CHANGE TO FLAG NOTE 6: IS: IP65, WAS: IP67	RA 01/08/18	EM	LN

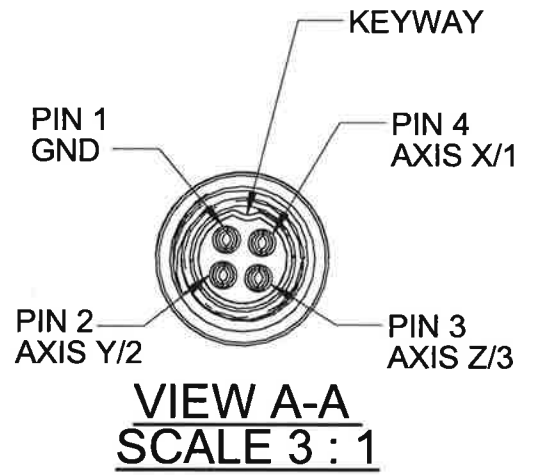
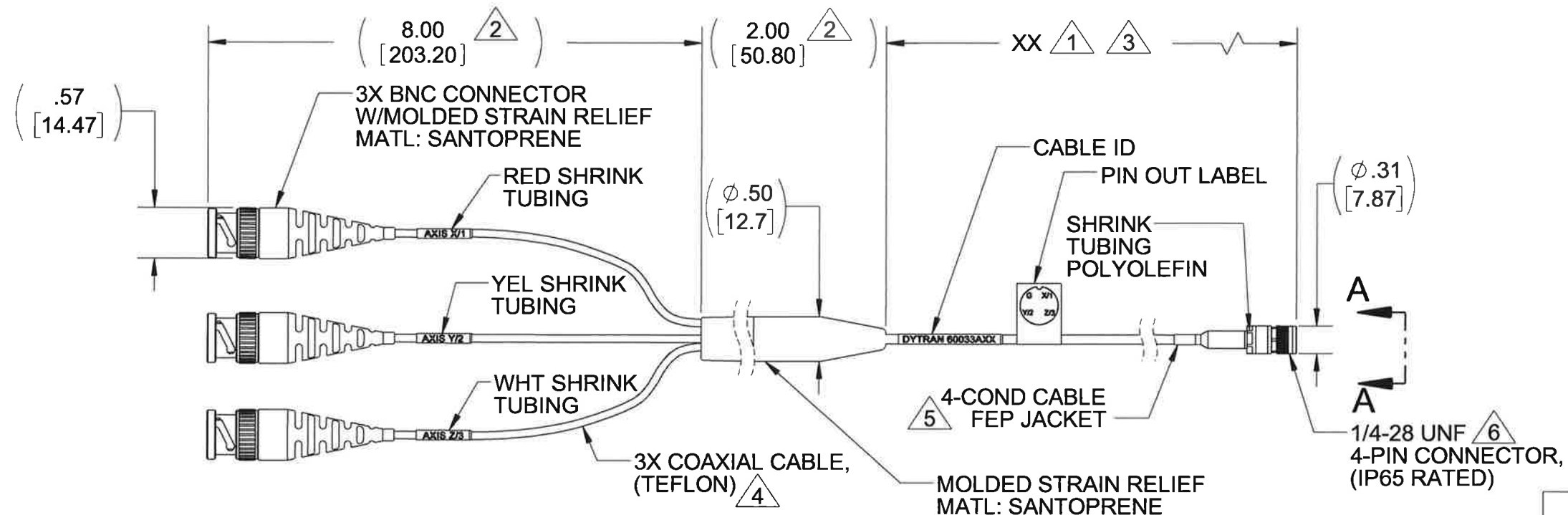

5 4 CONDUCTOR, SHIELDED CABLE	
WIRE	30 AWG 7/38 SILVER PLATED COPPER
SHIELD	SILVER PLATED COPPER BRAID, 90% MIN COVERAGE
JACKET	FEP, BLACK, .006/.015 WALL
DIAMETER	.105 MAX
TEMP	-65 °C (-85 °F) TO +200 °C (+392 °F)
VOLTAGE	250 VOLTS

- 6 IP 65 RATING IN MATED CONDITION, SEE SHEET 2 OF 2.
- 5 SEE TABLE FOR 4 CONDUCTOR CABLE SPECIFICATION.
- 4 SEE TABLE FOR SINGLE CONDUCTOR CABLE SPECIFICATION, SEE SHEET 2 OF 2.
- 3 OPERATING TEMPERATURE: -67 °F (-55 °C) TO 275 °F (135 °C)
- 2 TEMPERATURE RATING: -55 °C TO 110 °C (67 °F TO 230 °F).
- 1 PART NUMBER 60033AXX. "XX" DENOTES LENGTH IN FEET.

NOTES: UNLESS OTHERWISE SPECIFIED

UNLESS OTHERWISE SPECIFIED: INTERPRET DIM & TOL PER ASME Y14.5M - 1994. REMOVE BURRS. COUNTERSINK INTERNAL THDS 90° TO MAJOR DIA. CHAM EXT THDS 45° TO MINOR DIA. THD LENGTHS AND DEPTHS ARE FOR MIN FULL THDS. DIMENSIONS APPLY AFTER FINISHING.

ALL MACHINED SURFACES. TOTAL RUNOUT WITHIN .005. BREAK SHARP EDGES .005 TO .010. MACHINED FILLET RADII .005 TO .015. WELDING SYMBOLS PER AWS A2.4. ABBREVIATIONS PER MIL-STD-12.

DECIMALS		METRIC		ANGLES ±1°
.XX ±.03	.X ±.08	.X ±.08	.XX ±0.25	
.XXX ±.010	.XX ±0.25			
APPROVALS		DATE		
ORIG	LA	10/27/16		
CHK	EM	05/30/17		
APP	LN	06/07/17		
DO NOT SCALE DRAWING		THIRD ANGLE PROJECTION		

DYTRAN INSTRUMENTS, INC. Chatsworth, CA

MASTER COPY ONLY IF IN RED

TITLE: **OUTLINE/INSTALLATION DRAWING, CABLE ASSY, MINI 4-PIN PLUG TO (3) BNC**

SIZE	CAGE CODE	DWG NO	REV
B	2W033	127-60033A	C

SCALE: 1:1 SHEET 1 OF 2

PROPRIETARY AND CONFIDENTIAL

THE INFORMATION CONTAINED IN THIS DRAWING IS THE SOLE PROPERTY OF DYTRAN INSTRUMENTS INC. ANY REPRODUCTION IN PART OR AS A WHOLE WITHOUT THE WRITTEN PERMISSION OF DYTRAN INSTRUMENTS INC. IS PROHIBITED

SHRINK TUBING

RETRACT NUT EXPOSING
CONN. BODY

O-RING

SENSOR 3023A WITH 4-PIN CONN. REF

3023A CONN. SEATED
OVER O-RING, FULLY
MATED BY HAND

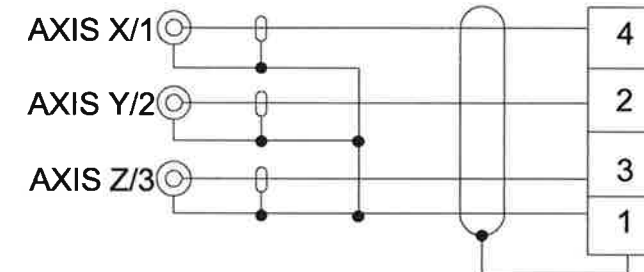

SCHEMATIC DIAGRAM

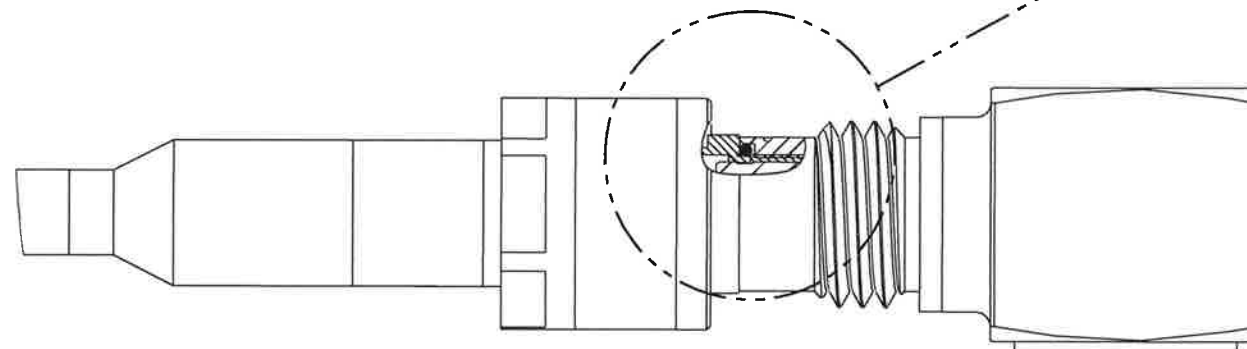
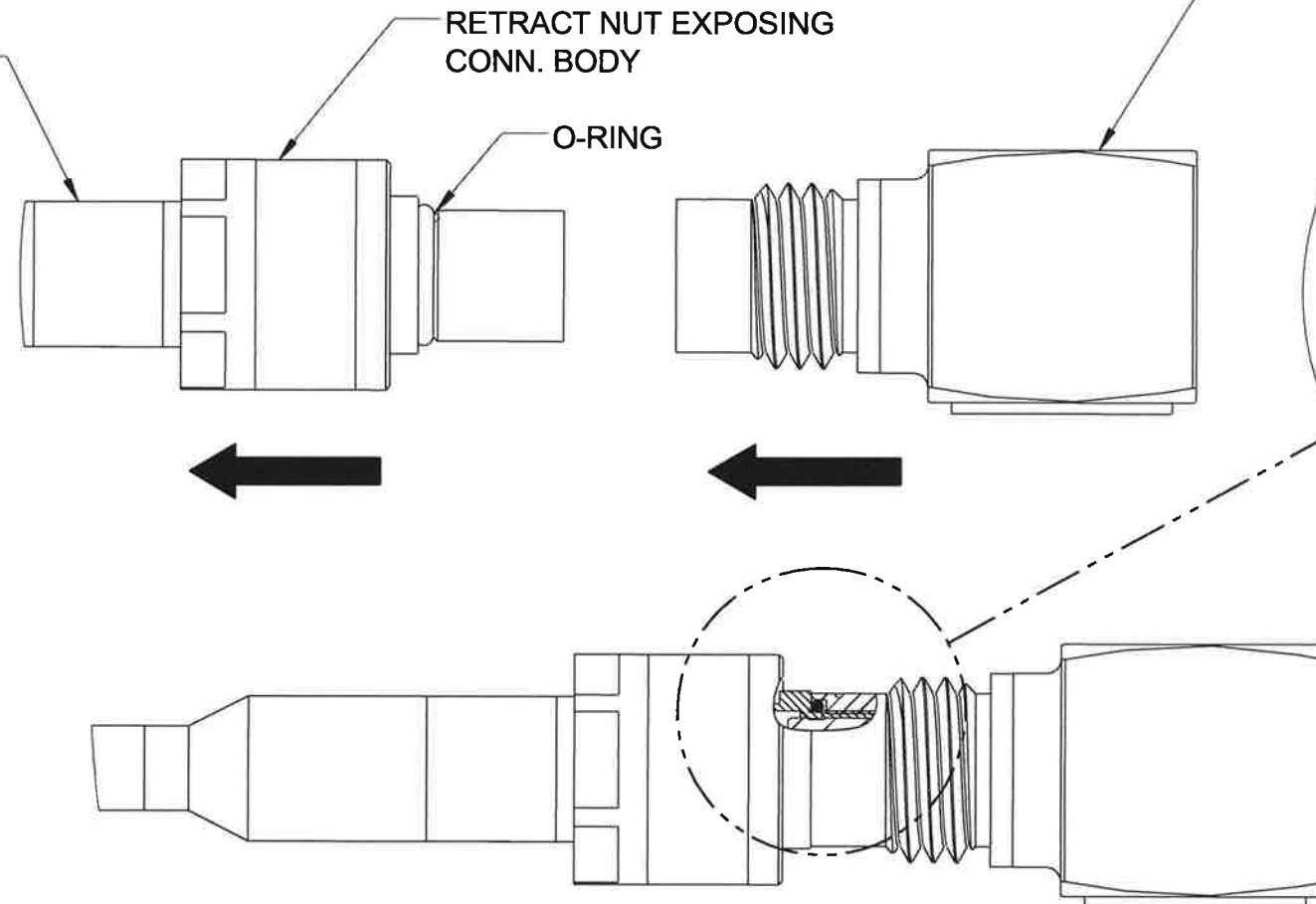

NUT TIGHTENED BY HAND
DRAWING PARTS TOGETHER

6 CONNECTOR MATING DETAIL
SCALE: 2:1

4 SINGLE CONDUCTOR SHIELDED CABLE	
WIRE	30-7/38 SILVER PLATED COPPER
WIRE INSULATION	EXTRUDED PTFE, NATURAL, Ø.033 ±.002
SHIELD	38 AWG SILVER PLATED COPPER BRAID, 95% MIN COVERAGE, Ø.054 NOM
JACKET	WHT PTFE WRAP .005-.010 WALL
DIAMETER	Ø.074±.006
TEMP	200 DEG C WIRE RATED
VOLTAGE	2000 VAC
INDUCTANCE	.80 microH/FT
MINIMUM BEND RADIUS	.38 IN
CAPACITANCE (SHIELD TO CONDUCTOR)	32 pF/FT
IMPEDANCE	50 OHMS



TITLE: **OUTLINE/INSTALLATION
DRAWING, CABLE ASSY, MINI
4-PIN PLUG TO (3) BNC**

SIZE B	CAGE CODE 2W033	DWG NO 127-60033A	REV C
SCALE: 1:1	PART NO:	SHEET 2 OF 2	