

REVISIONS					
REV.	ECN	DESCRIPTION	BY/DATE	CHK	APPR
A	15327	INITIAL RELEASE	KG 02/17/20	AM	[Signature]

PROPRIETARY AND CONFIDENTIAL

THE INFORMATION CONTAINED IN THIS DRAWING IS THE SOLE PROPERTY OF DYTRAN INSTRUMENTS INC. ANY REPRODUCTION IN PART OR AS A WHOLE WITHOUT THE WRITTEN PERMISSION OF DYTRAN INSTRUMENTS INC. IS PROHIBITED

MODEL	RANGE
4400B1	±2g
4400B2	±19g
4400B3	±200g

HARDWARE CHECK / READY INDICATOR LED

RECORDING INDICATOR LED

CHARGING INDICATOR LED

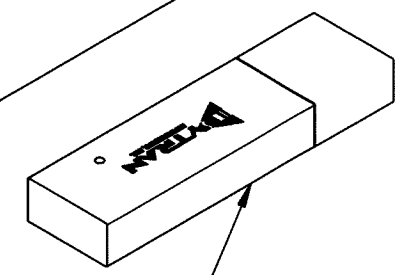
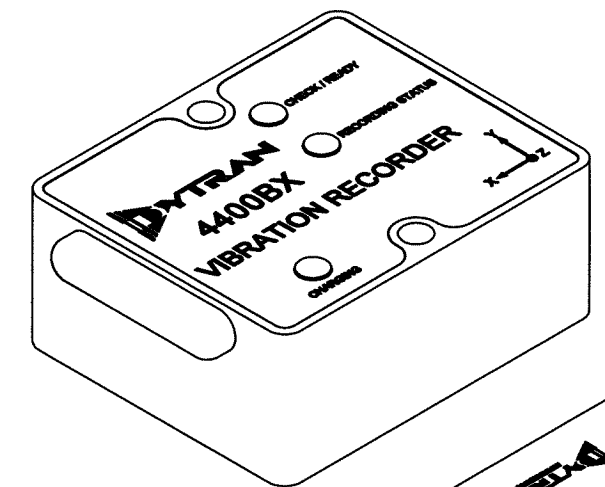
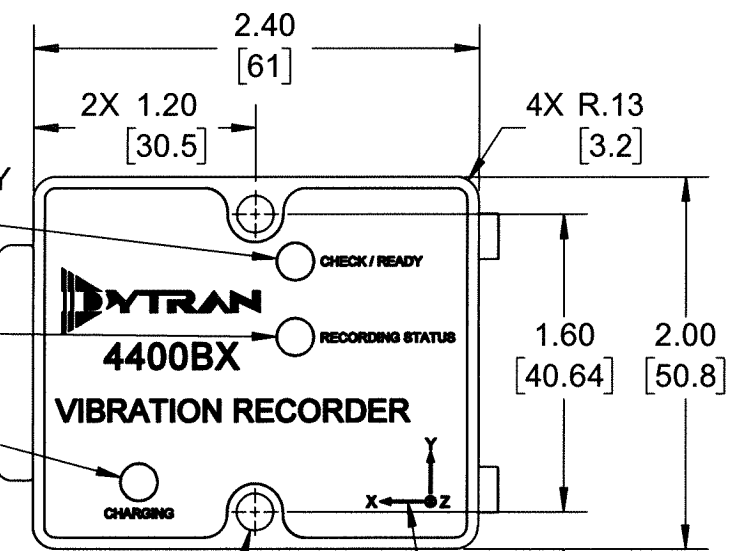

9007 SOFTWARE, SUPPLIED

POWER BUTTON

RECORD BUTTON

RECORD BUTTON

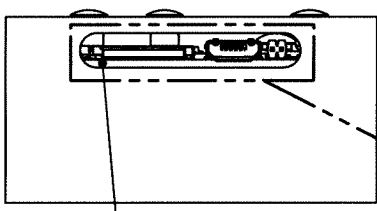
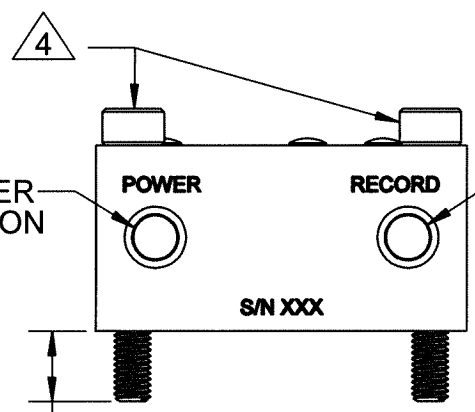

MOLDED COVER NOT SHOWN FOR CLARITY

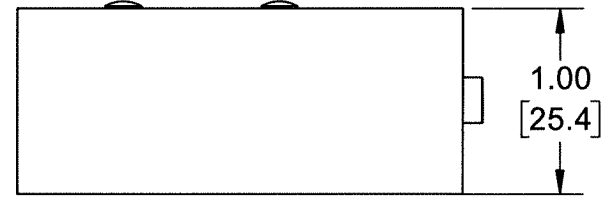

(2X .38 [9.6])

RARE EARTH MAGNETS, PERMANENTLY INSTALLED

BATTERY CHARGING PORT, MICRO-USB

MICRO-SD CARD SLOT

SYNCHRONIZATION CONNECTOR

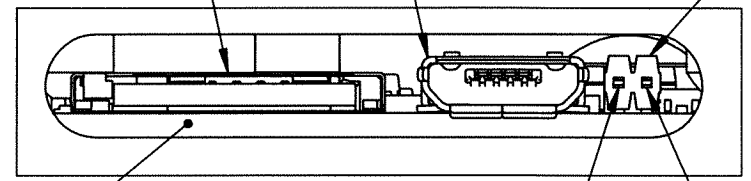

MOLDED COVER NOT SHOWN FOR CLARITY

DETAIL A
SCALE 3:1

MOLDED COVER

BOTTOM COVER, REMOVABLE

8 MOLDED COVER AND BOTTOM COVER MUST BE INSTALLED TO MEET IP RATING.

7 MATING SYNCHRONIZATION CABLE: DYTRAN MODEL 60153AXX.

6 ARROWS INDICATE DIRECTIONS OF ACCELERATION FOR POSITIVE OUTPUT.

5 MAGNETS PULL RATING: UP TO 8.4 lb.
NOTE: MAXIMUM PULL RATINGS ARE BASED ON DIRECT CONTACT WITH RUST-FREE AND UNPAINTED IRON PLATE. VARIATIONS IN MATERIAL CONDITION WILL SIGNIFICANTLY REDUCE THESE RATINGS.

4 MOUNTING SCREW, MODEL 6246, 10-32 UNF-3A X 1.25, QTY 2, SUPPLIED.
MOUNTING SCREW, MODEL 6694A1, M5 X 0.8 X 35mm, QTY 2, SUPPLIED.

3. OPERATING TEMPERATURE, DISCHARGING: -4°F TO +140°F (-20°C TO +60°C)
OPERATING TEMPERATURE, CHARGING: +32°F TO +113°F (0°C TO +45°C)

2. HOUSING MATERIAL: ALUMINUM ALLOY, ANODIZED, COLOR: BLUE.

1. WEIGHT: 150 GRAMS, MAX.

NOTES: UNLESS OTHERWISE SPECIFIED

UNLESS OTHERWISE SPECIFIED: INTERPRET DIM & TOL PER ASME Y14.5M - 1994. REMOVE BURRS. COUNTERSINK INTERNAL THDS 90° TO MAJOR DIA. CHAM EXT THDS 45° TO MINOR DIA. THD LENGTHS AND DEPTHS ARE FOR MIN FULL THDS. DIMENSIONS APPLY AFTER FINISHING.	UNLESS OTHERWISE SPECIFIED: DIMENSIONS ARE IN INCHES. DIMENSIONS IN BRACKETS [] ARE IN MILLIMETERS TOLERANCES ARE:		DYTRAN INSTRUMENTS, INC. Chatsworth, CA		MASTER ONLY IF IN RED
	DECIMALS .XX ±.03 .XXX ±.010	METRIC X ± 0.8 .XX ±0.25	ANGLES ±1°	TITLE: OUTLINE/INSTALLATION DWG, VIBRATION RECORDER, MODEL 4400B	
	APPROVALS ORIG: KG CHK: AM APP: [Signature]	DATE 10/18/19 03/12/20 5/12/20	SIZE B	CAGE CODE 2W033	
	DO NOT SCALE DRAWING	THIRD ANGLE PROJECTION 	DWG NO 127-4400B	REV A	
ALL MACHINED SURFACES: 63/ TOTAL RUNOUT WITHIN .005. BREAK SHARP EDGES .005 TO .010. MACHINED FILLET RADII .005 TO .015. WELDING SYMBOLS PER AWS A2.4. ABBREVIATIONS PER MIL-STD-12.			SCALE: 1:1	SHEET 1 OF 1	

MODEL NUMBER 4400B1	PERFORMANCE SPECIFICATIONS	DOC NO. PS4400B1
--------------------------------------	-----------------------------------	-----------------------------------

	ACCELERATION RECORDER, TRIAXIAL	REV A, ECN 15327, 02/24/20
--	--	----------------------------



- RECORDS THREE-AXIS VIBRATION UP TO 15 HOURS
- IP64 RATED
- MICRO-SDHC CARD COMPATIBLE
- DUAL MOUNTING CONFIGURATIONS
- INTEGRATED ANTI-ALIASING FILTERS

PHYSICAL

		ENGLISH		SI	
Weight, Max.		5.3	oz	150	grams
Mounting		Screws / Magnets		Screws / Magnets	
Housing	Material	Aluminum, Anodized		Aluminum, Anodized	

PERFORMANCE

		ENGLISH		SI	
Acceleration Range		±2	Gpeak	±20	m/s ² peak
Maximum Frequency Range, -3dB		0 to 1000	Hz	0 to 1000	Hz
Resonance Frequency		>5.5	kHz	>5.5	kHz
Linearity [1]		< ±2.0	%F.S.	< ±2.0	%F.S.
Transverse Sensitivity, Max		5	%	5	%
Noise, Max.		0.01	G rms	88	mm/s ² rms
Recording Time, Max.		15	hours	15	hours
Sampling rate		100 - 10,000	samples/s	100 - 10,000	samples/s
Memory Card Type		Micro-SDHC		Micro-SDHC	
Acquisition Type		Free Run / Triggered / Time		Free Run / Triggered / Time	

ELECTRICAL

Battery	1300mAh (Rechargeable)	1300mAh (Rechargeable)
---------	------------------------	------------------------

ENVIRONMENTAL

		ENGLISH		SI	
Shock Max		1,000	g pk	9810	m/s ²
Vibration Max		100	g pk	981	m/s ²
Operating Temperature, Discharging		-4 to +140	°F	-20 to +60	°C
Operating Temperature, Charging		+32 to +113	°F	0 to +45	°C
Seal [3]		Environmental / IP64		Environmental / IP64	

Model	Range (Gpeak)	Noise (G rms)	Oper. Temp (°F)	BandWidth (Hz)
4400B2	±19	0.02	-4 to +140	0 to 1000
4400B3	±200	0.2	-4 to +140	0 to 1000

Refer to the performance specifications of the products in this family for detailed description

Supplied Accessories:

- 1) Accredited calibration certificate (ISO 17025)
- 2) Mounting Screw, Model 6246, 10-32 X 1.25, Qty. 2
- 3) Mounting Screw, Model 6694A1, M5x0.8 X 35mm, Qty. 2
- 4) 9007 Software

Notes:

- [1] Linearity is % of specified full scale (or any less full-scale range), zero-based best fit straight line method.
- [2] In the interest of constant product improvement, we reserve the rights to change the specifications without notice. It is the customer's responsibility to validate that a particular product with the properties described in the product specification is suitable for use in a particular application. Parameters provided in datasheets and / or specifications may vary in different applications and performance may vary overtime. All operating parameters, including typical parameters, must be validated for each customer application by the customer's technical experts.
- [3] Molded cover and bottom cover with integral sealing gasket must both be installed to meet IP64 rating.

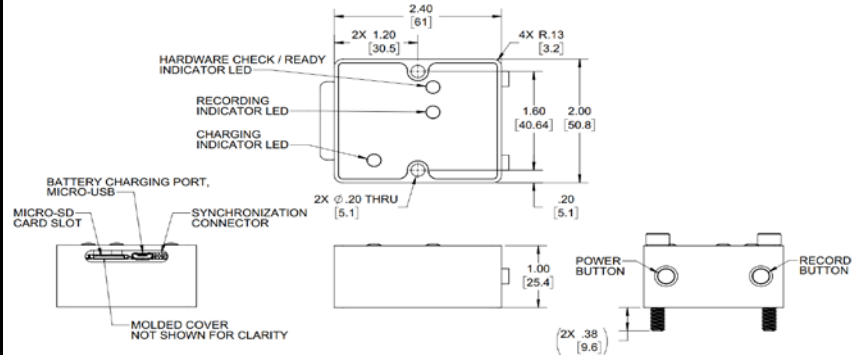

Units on the line drawing are in inches, units in brackets are in millimeters. Refer to 127-4400B for more information.